

# PRODUCT TECHNICAL DATASHEET

# BI/004

Brushless 

Intensive use 

Digital Encoder 



CODE	DESCRIPTION	PCS/PALLET
<b>BI/004</b>	36V DC BIONIK BRUSHLESS barrier for 3 or 4 metre booms, with control unit and on board native encoder, complete with a fastening base with tie rods and screws and boom fastening angles.	8

PRODUCT TECHNICAL SPECIFICATIONS	
Barriers	Up to 4 mt long
Power line supply	230V AC - 50 Hz
Motor power supply	36V DC
Electrical absorption	0-15A
Power rating	220W
Frequency of use	Continue use
Torque	0 - 200 N m
Operating temperature	- 20 + 55 C°
Protection level	IP54
Reductor Type	Irreversible
Opening time at 90°	2÷6 sec (up to 3 m) - 3÷6 sec (up to 4 m)
Onboard control unit	CTRL Digital Controller 36V DC
Encoder	Digital native encoder + magnetic digital SENSORED, 4096 PPR
Accessories power supply	24V DC
Release system	STANDARD Key cylinder - Optional European Cylinder (Cod. RL670)
Batteries recovery	Available (optional)
BUS synchronization Master/Slave	Yes
Operating cycles per day (opening/closing - 24 hours no stop)	5000 cycles

Maximum dimension product in mm (L x W x H)	280 x 210 x 1203
Product weight packed (Kg)	47,5
Number items per pallet	8

# PRODUCT DIMENSIONS AND PREPARING FOR INSTALLATION

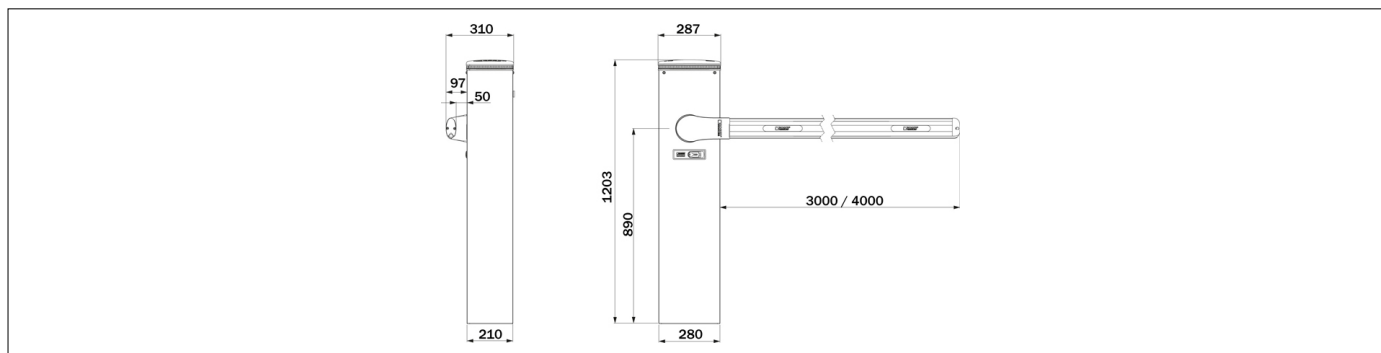

DIMENSIONS

## PRODUCT ACCESSORIES

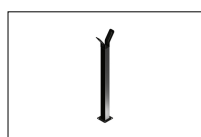

**BAFS/01**  
Fixed support for bars.



**BAFS/02**  
Fixing support, adjustable.

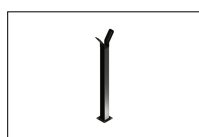

**BAFS/03**  
Fixing support with bolt predisposition for bars.

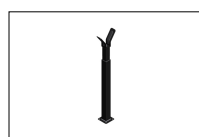

**BAFS/04**  
Fixing support adjustable, with bolt predisposition for bars.



**BAFS/05**  
Adjustable fixed support with vandal-proof magnetic suction cup complete with B72/DGS demagnetizer card

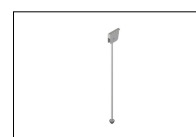

**BAMS/01**  
Mobile support for bars.

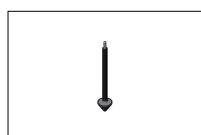

**BAMS/01/EXT**  
Extension 20cm for mobile support BAMS/01.



**BA/68/3**  
White painted aluminum rod, 3 meters long, with LED cover profile and impact resisting rubber profile.



**BA/68/4**  
White painted aluminum rod, 4 meters long, with LED cover profile and impact resisting rubber profile.

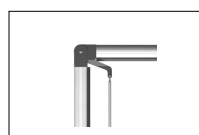

**SND/BA/68/DW**  
Articulated joint 90° with lower tie rod for boom arms BA/68.

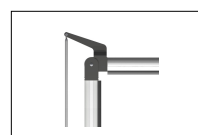

**SND/BA/68/UP**  
Articulated joint 90° with upper tie rod for boom arms BA/68.

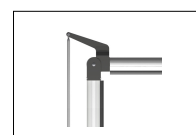

**SND/BA/68/UP/RD**  
Articulated joint 90° with upper tie rod (lowered version) for boom arms BA/68.

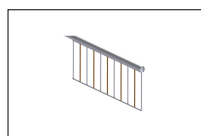

**BARK/02**  
Barrier skirting in aluminum, with stainless steel screws mounted on bronze bushings. Single module of length 2 meters.



**ACS/BA/60**  
Break-away system for barrier, compatible only with BA/60/3 boom arm.



**ACS/BA/68**  
Break-away system for barrier, compatible with BA/68/3 and BA/68/4 boom arm.



**BI/BAT/KIT**  
Kit for emergency batteries charger for brushless digital controller CTRL 36V DC with plug-in card, with 2 recovery batteries 12V DC, 4.5 Ah. Kit for BIONIK barrier.



**BI/BCHP**  
Plug-in card, batteries charger, for brushless digital controller CTRL 36V DC, without recovery batteries, for BIONIK barrier.



**BT12V45**  
Battery 12V 4.5 Ah.



**B71/PBX36/BOX**  
Battery chargers with solar panels for powering Brushless digital controllers at 36V DC in network mode



**B71/PBX36/BOX/115**  
Battery chargers with solar panels for powering Brushless digital controllers at 36V DC in network mode



**B71/PBX/BOX**  
Battery chargers with solar panels for powering Brushless digital controllers in FULL SOLAR mode

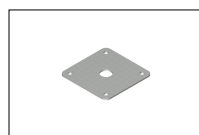

**KT231**  
Fixing plate for code BAFS/01, BAFS/02, BAFS/03, BAFS/04, BAFS/05.

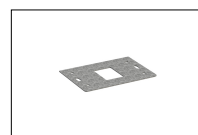

**KT240**  
Fixing plate with stay bolts and screws for series Bionik.



**B73/EXP**  
Signal status board, 2 output for CTRL - CTRL/P

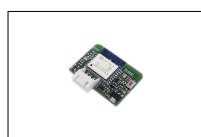

**B74/BCONNECT**  
Module WI-FI B-CONNECT - Management and programming system in IP web mode, via P2P hot spot Wi-Fi connection for 36V brushless digital controller (EDGE1 - CTRL - CTRL/P - B70/1DCHP)



**SP/48/01**  
Spring diameter 48 mm for barriers.



**SP/61/01**  
Spring diameter 61 mm for barriers.



**SP/72/01**  
Spring diameter 72 mm for barriers.

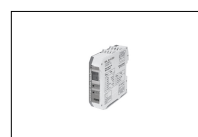

**DLD1/24**  
Loop detector for 1 loop, 2 output, 24V AC/DC.

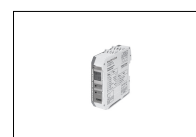

**DLD2/24**  
Loop detector for 2 loop, 2 output + output alarm, 24V AC/DC.



**RL670**  
European cylinder key for release  
system series SMARTY - BIONIK.

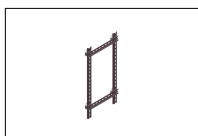

**KT239**  
Kit DIN rail with magnetic support.



**KT242**  
Cable passage kit, with magnetic  
support, for barriers.



**ALED/4C**  
Luminous led cord of 4 meters for  
bar up to 4 meters with connection  
cable.



**R99/BASB20**  
Pack of 20 stickers for barrier.



**R99/BASB40**  
Pack of 40 stickers for barrier.